

Reference to NAKURU TOWNSHIP Co-ordinates

Station	From	To	Height	Class of Station
ALP	8384.72	1584.64		ARCU. Old
AL15	7915.77	1526.09		"
AL16	7916.90	1585.01		"
AL17	7918.36	2085.89		"
AL18	7944.96	2243.21		"
AL20	7228.00	2330.39		"
AL21	7058.24	2335.61		"
AL22	7058.25	1878.54		"
AL24	7057.41	1578.80		"
AL24	7494.41	1383.37		"
AD1/34	6653.25	2716.52		"
UPB	7763.91	2494.42		"
UPB	6490.71	3028.71		"
AL1X	6384.02	2254.21		IPC. New
AL18X	7193.34	2373.37		"
AD5	663.47	1503.69		"
AD8	7842.95	1945.60		"
AD10	8127.46	1744.20		"
UP7X	7221.93	2703.32		IPC. New
A	6592.94	2674.95		IPC. Old (Plan No 48559-52 (61/13))
AD1	7193.34	2373.37		IPC. New (Nakuru No 64)
N1	7102.71	1530.32		Theor.
N4	7459.11	1530.55		"
S/NK III	6202.17	1840.34		"
S/NK IV	6202.17	1840.34		"
TEMP II (S)	6301.64	2675.74		"
CN1	8039.52	2221.82		IPC. New
CN2	7444.78	2028.27		"
CN3	2282.79	1966.08		"
CN4	8283.61	2166.78		"
NE1	8384.72	1584.64		IPC.
NFA	8384.72	1584.64		Not Meas'd
NF1	7358.84	1895.86		IPC. New
NFA	7929.03	1600.86		"
NF5	7929.07	1530.86		"
NF24	8289.07	1531.07		"
NF28	8289.03	1601.07		"
NF28	8288.84	1896.07		"
NG1	7549.07	1523.80		IPC.
NG2	7633.77	1530.82		"
NH1	7044.73	1485.28		IPC.
NH1	6348.12	1900.37		"
NH3	7043.87	1900.44		"
NH1B	7043.87	2365.29		"
NH15	6043.87	2701.78		"
NH17	6347.59	2746.75		"
NH18	6347.59	2365.22		"
NJ1	7284.63	2286.06		"
NJ2	7284.63	2103.10		"
NT1	7675.68	2230.36		"
NT2	7675.68	2103.10		"
NT10	7675.68	2103.10		"
NH1V	7683.75	2099.22		"
NH1V	7683.75	2413.52		"
NK1	7043.87	1600.86		"
NK2	7043.87	1600.86		"
NK16	7203.41	2031.49		"
School	7203.41	1600.86		"
School NW	7203.41	2031.49		"

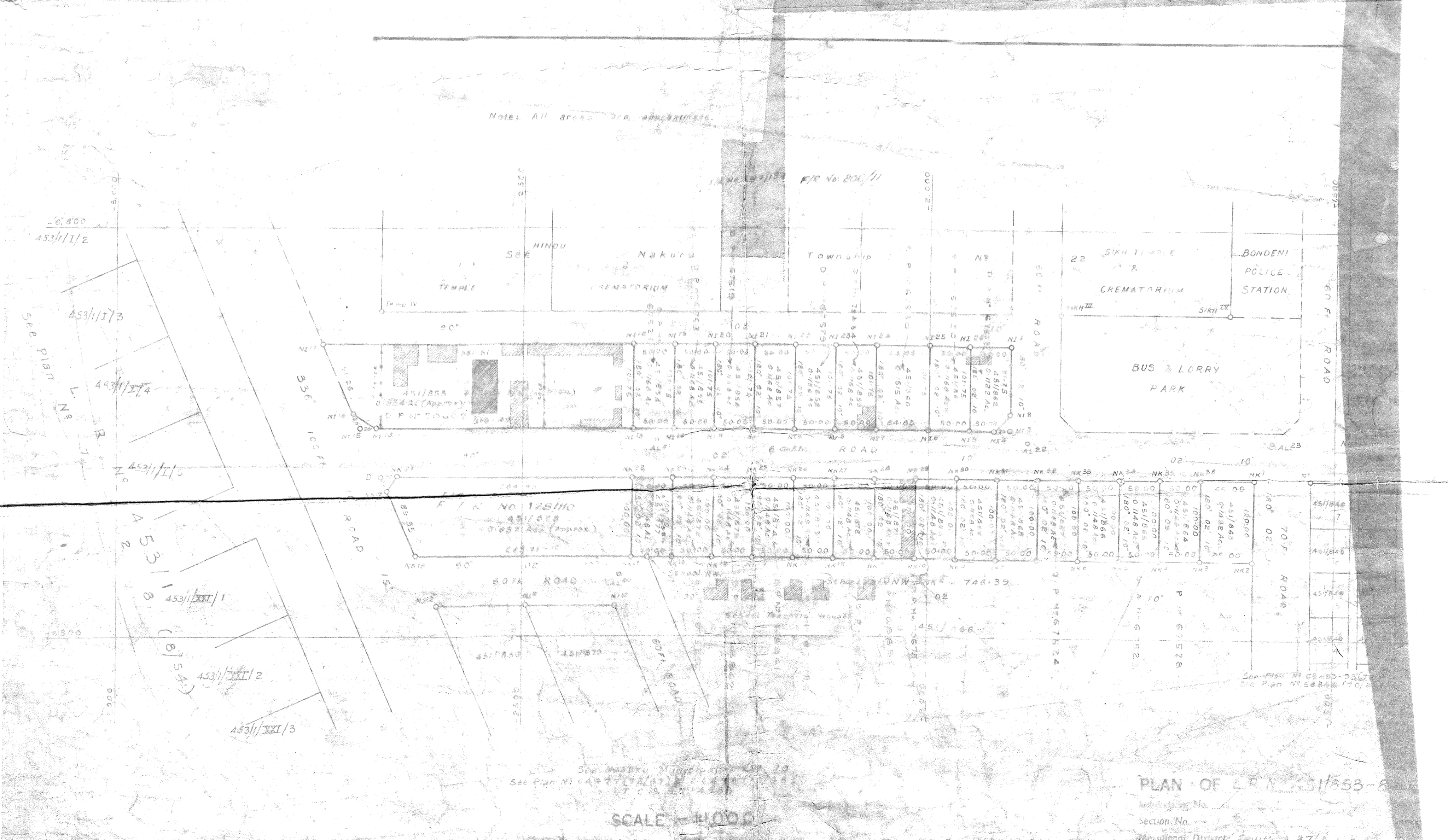

Line	Bearing	Distance
N13 - N14	225.00°	10.00
N14 - N15	278.00°	10.00
N15 - N16	330.00°	10.00
N16 - N17	30.00°	10.00
N17 - N18	90.00°	10.00
N18 - N19	150.00°	10.00
N19 - N20	210.00°	10.00
N20 - N21	270.00°	10.00
N21 - N22	330.00°	10.00
N22 - N23	30.00°	10.00
N23 - N24	90.00°	10.00
N24 - N25	150.00°	10.00
N25 - N26	210.00°	10.00
N26 - N27	270.00°	10.00
N27 - N28	330.00°	10.00
N28 - N29	30.00°	10.00
N29 - N30	90.00°	10.00
N30 - N31	150.00°	10.00
N31 - N32	210.00°	10.00
N32 - N33	270.00°	10.00
N33 - N34	330.00°	10.00
N34 - N35	30.00°	10.00
N35 - N36	90.00°	10.00
N36 - N37	150.00°	10.00
N37 - N38	210.00°	10.00
N38 - N39	270.00°	10.00
N39 - N40	330.00°	10.00
N40 - N41	30.00°	10.00
N41 - N42	90.00°	10.00
N42 - N43	150.00°	10.00
N43 - N44	210.00°	10.00
N44 - N45	270.00°	10.00
N45 - N46	330.00°	10.00
N46 - N47	30.00°	10.00
N47 - N48	90.00°	10.00
N48 - N49	150.00°	10.00
N49 - N50	210.00°	10.00
N50 - N51	270.00°	10.00
N51 - N52	330.00°	10.00
N52 - N53	30.00°	10.00
N53 - N54	90.00°	10.00
N54 - N55	150.00°	10.00
N55 - N56	210.00°	10.00
N56 - N57	270.00°	10.00
N57 - N58	330.00°	10.00
N58 - N59	30.00°	10.00
N59 - N60	90.00°	10.00
N60 - N61	150.00°	10.00
N61 - N62	210.00°	10.00
N62 - N63	270.00°	10.00
N63 - N64	330.00°	10.00
N64 - N65	30.00°	10.00
N65 - N66	90.00°	10.00
N66 - N67	150.00°	10.00
N67 - N68	210.00°	10.00
N68 - N69	270.00°	10.00
N69 - N70	330.00°	10.00
N70 - N71	30.00°	10.00
N71 - N72	90.00°	10.00
N72 - N73	150.00°	10.00
N73 - N74	210.00°	10.00
N74 - N75	270.00°	10.00
N75 - N76	330.00°	10.00
N76 - N77	30.00°	10.00
N77 - N78	90.00°	10.00
N78 - N79	150.00°	10.00
N79 - N80	210.00°	10.00
N80 - N81	270.00°	10.00
N81 - N82	330.00°	10.00
N82 - N83	30.00°	10.00
N83 - N84	90.00°	10.00
N84 - N85	150.00°	10.00
N85 - N86	210.00°	10.00
N86 - N87	270.00°	10.00
N87 - N88	330.00°	10.00
N88 - N89	30.00°	10.00
N89 - N90	90.00°	10.00
N90 - N91	150.00°	10.00
N91 - N92	210.00°	10.00
N92 - N93	270.00°	10.00
N93 - N94	330.00°	10.00
N94 - N95	30.00°	10.00
N95 - N96	90.00°	10.00
N96 - N97	150.00°	10.00
N97 - N98	210.00°	10.00
N98 - N99	270.00°	10.00
N99 - N100	330.00°	10.00



SCALE 1:1000

SURVEY RECORDS OFFICE
13 Nov 1956
Computations No. 210/11/55
Field Book No. 210/11/55
Page No. 104

PLAN OF L.R. No 151/558

Section No. _____
Municipal District No. 437/1 C.I.
Administrative District Nakuru
LOCALITY Nakuru Municipal
PROVINCE Rift Valley

I hereby certify that I, in person, made and on the 31st of Nov 1956 conducted the survey represented by this plan, all which are within the boundaries and limits of the area surveyed by me, and that the survey has been executed in accordance with the existing regulations and with the approved scheme.

Surveyor

(Sd) C.E. Helmsberg
Divisional Surveyor, Nakuru

76
46